

Hito

INSTALLATION MANUAL

HITO

Ref.#: SM.07.647._._01

(metal.whiskyglass)

6W AC LED module

3000K, RA80+, 440lm



IMPORTANT

Always shut off power before cleaning and maintenance.



All products are manufactured to meet or exceed North American standards C22.2-250, UL 1598, C22.2-12, C22.2.9, UL 153.

All preparation for installation of fixture is to be provided by the end user.

The description and measurements on this drawing are for information purposes only.

VISO © 2021 All rights reserved.



VISO LIGHTING

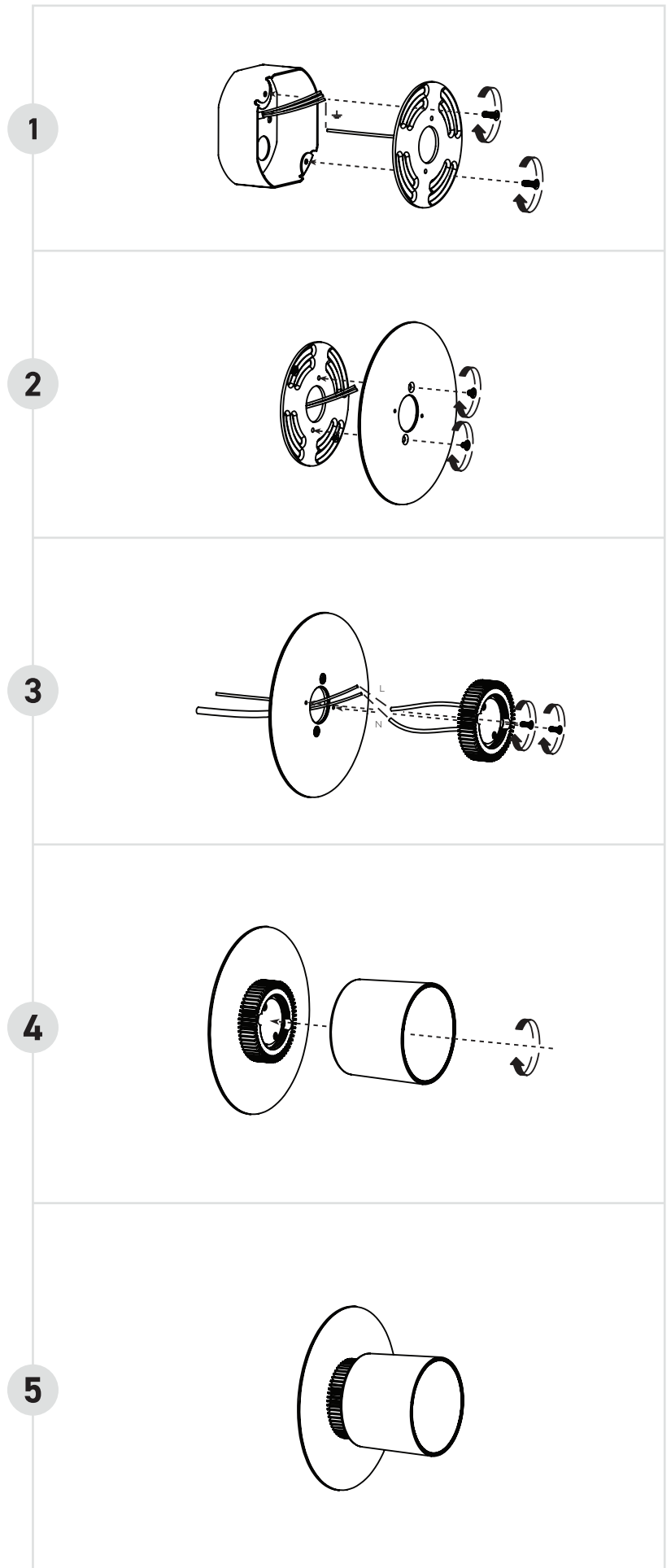

Hito

INSTALLATION MANUAL

HITO SCONCE

Ref.#: SM.07.647._._02

(metal.wineglass)

6W AC LED module

3000K, RA80+, 440lm



IMPORTANT

Always shut off power before cleaning and maintenance.



All products are manufactured to meet or exceed North American standards C22.2-250, UL 1598, C22.2-12, C22.2.9, UL 153.

All preparation for installation of fixture is to be provided by the end user.

The description and measurements on this drawing are for information purposes only.

VISO © 2021 All rights reserved.



VISO LIGHTING

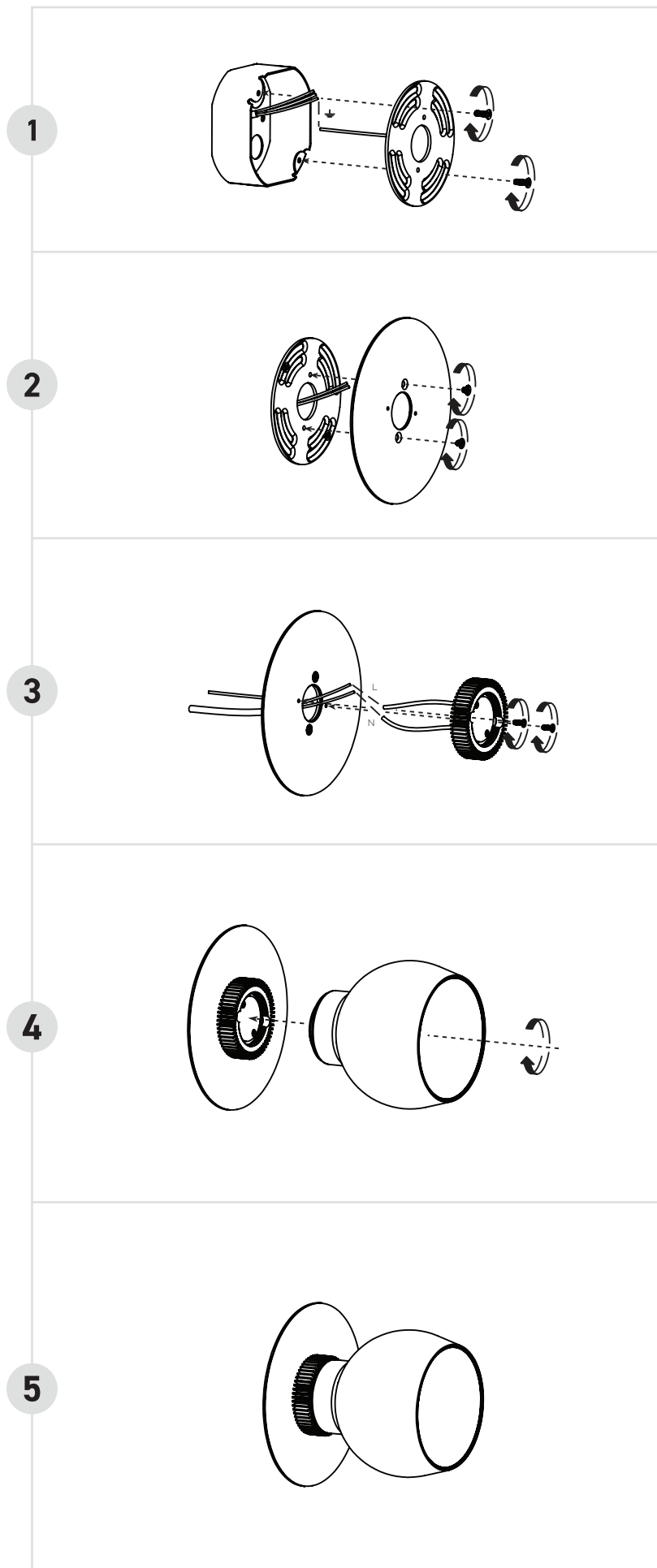

Hito

INSTALLATION MANUAL

HITO SCONCE

Ref.#: SM.07.647._._03

(metal.martiniglass)

6W AC LED module

3000K, RA80+, 440lm



IMPORTANT

Always shut off power before cleaning and maintenance.



All products are manufactured to meet or exceed North American standards C22.2-250, UL 1598, C22.2-12, C22.2.9, UL 153.

All preparation for installation of fixture is to be provided by the end user.

The description and measurements on this drawing are for information purposes only.

VISO © 2021 All rights reserved.



VISO LIGHTING

